



"Beyond Telling Time"

USER MANUAL

• Brand Story	03
• General Information	04
• Operating Instructions	06
- Quartz 2 Hands and 3 Hands Instructions	06
- Quartz Multifunction Instructions	08
- Quartz Chronograph Instructions	12
- Quartz GMT Instructions	18
- Automatic Instructions and Maintenance	22
- Deployment Clasp and Buckle Instructions	24
• Water Resistance	26
• SAPPHITEK™ Crystal Warranty	27

To serve you better please register your watch at www.witnesswatch.com/help.



Brand Story

ELINI BAROKAS

In today's world of pace-setting timepieces, many watches simply tell time. An Elini Barokas watch goes beyond the ordinary standards of time, providing an extraordinary time-keeping experience, steeped in excellence that also makes a highly-stylized statement on your wrist.

Modern, innovative in design, bold and intricate in detail, Elini Barokas watches capture the spirit of today's urbane and sophisticated men and women...fashion-forward individuals who do not simply follow the trends, they set their own.

The Elini Barokas award-winning brand is recognized around the globe for their creative and innovative designs, as well as incomparable high quality. It's no wonder heads-of-state, prominent celebrities and artists have counted on Elini Barokas watches for decades.

ELINI BAROKAS

"Beyond Telling Time"

We congratulate you on receiving your Elini Barokas watch and thank you for your purchase.

General Information:

- It is recommended to rinse your watch with fresh water after contact with salt water.
- It is recommended not to use the crown or pushers if the watch is wet **and certainly not while it is immersed in water.**
- Water resistant watches should be inspected and serviced once a year.

Helpful Watch Tips:

- **A Quartz Watch** is battery powered and does not require winding. Eventually the battery will need to be replaced.
- **An Automatic Watch** is a mechanical watch that winds itself and does not require a battery. When worn daily, the movement of your wrist causes the mainspring to wind progressively, eliminating the need for additional winding. To start your automatic, you can hand wind it by rotating the crown clockwise a number of turns while in its normal operating position (screw down crowns will need to be unscrewed first), or by swinging it side to side for 30 seconds. We recommend housing an automatic in a watch winder box.

- **A Manual Wind Watch** is a mechanical watch that does not require a battery, but can only be wound by hand. To wind it, turn the crown clockwise while it is in its normal operating position until you feel resistance. This type of watch should be wound daily.
- **For Automatic and Mechanical** watches, it is strongly recommended to avoid adjusting the date, month, year or any other functions between 9PM to 2AM. Also, most automatic and mechanical watches should not be worn while doing sports or golfing activity due to possible shock damage to the mechanisms inside the movements.

Important Things to Know:

- Many Elini Barokas watches are equipped with a screw down crown to help prevent water infiltration. For watches with a screw down, you must first gently rotate the crown counter-clockwise until it springs out. The crown must then be gently pulled out to the appropriate position for time or date setting.
- Never correct date between 9:00PM and 1:00AM.
- It is very important after setting your watch that you gently push in and screw down the crown firmly to ensure water resistance.
- Not screwing down the crown will cause water damage and void warranty.
- To serve you better please register your watch at www.witnesswatch.com/help.

Operating Instructions

Not all movements may be displayed in this booklet. If you do not find operating instructions for your model, please visit www.witnesswatch.com to search your style and click on User Manual.

Quartz 2 Hands and 3 Hands Instructions

(ISA 2331, ISAK83, ISAK62 or similar)

Time Setting For Models without Calendar

- Gently unscrew crown counter-clockwise and/or pull out the crown to Position 2.
- Adjust the time by turning the crown in the desired direction.
- Gently push in and/or screw down the crown clockwise back into Normal Position.

Time Setting For Models without Calendar and Crown

- To adjust time push button is located on the case back.
- Push continually for quick setting and push step by step to adjust the minute.

Time Setting For Model with Calendar

- Gently unscrew crown counter-clockwise and/or pull out the crown to Position 2.
- Turn the crown until the preview days date appears in the calendar frame.
- Pull out the crown to Position 3, and advance the hour and the minute hands until the desired date appears.

(Please set time according to AM or PM).

- Adjust the time by turning the crown in the desired direction.
- Gently push in and/or screw down the crown clockwise back into Normal Position.

Note: For best accuracy when setting your timepiece. If your watch has three hands, gently pull out the crown when the second hand points at the 12 o'clock or "00" seconds.

(1 = Normal Position, 2 = Calendar Position, 3 = Time Setting Position)

Important Note:

It is very important after adjusting the date and setting the time on your watch that you gently push in and screw down the crown firmly to ensure water resistance. Not doing so will void warranty.



ISA2331/103
(NO DATE)



ISA2331/103
(DATE)

Quartz Multifunction Instructions

(ISA9238, ISA9230, ISA9239 or similar)

Watch Functions: Hour, Minute and Second Hands. Counters Date of the Month, Dual Time 24H and Day of the Week.

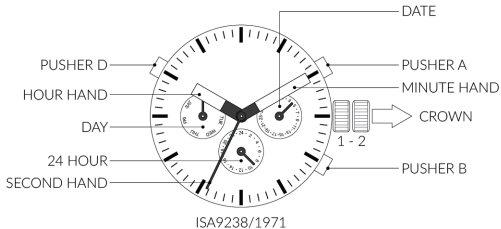

Time Setting

- Gently unscrew crown counter-clockwise and/or pull out the crown to Position 2.
- Adjust the time by turning the crown in the desired direction.
- Gently push in and/or screw down the crown clockwise back into Normal Position.

Date Setting

- Crown remains in Normal Position.
- Press Pusher A step by step to adjust the desired date.

Dual Time Setting

- Crown remains in Normal Position.
- Press Pusher B step by step to adjust the desired dual time.

Warning: The minute hand must be set between 55th minute and 05th minute at any hour.

Day Setting

- Gently unscrew crown counter-clockwise and/or pull out the crown to Position 2.
- Press Pusher D step by step to adjust the desired date.

Warning: The day advances one day between 4h30 AM and 6h30 AM. Do not use quick correction to set the day between 22:00 and 6:30.

Watch Functions: Hour, Minute and Second Hands. Counters Date of the Month, 12H Second Time Zone with Day/Night Indicator and Day of the Week.

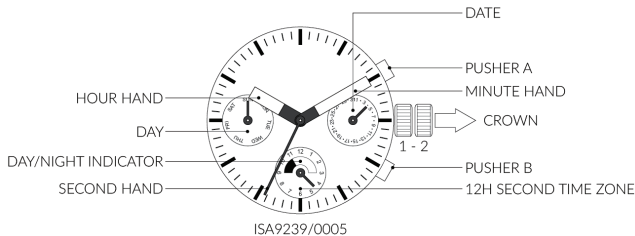

Time Setting

- Gently unscrew crown counter-clockwise and/or pull out the crown to Position 2.
- Adjust the time by turning the crown in the desired direction.
- Gently push in and/or screw down the crown clockwise back into Normal Position.

Day Setting

- Gently unscrew crown counter-clockwise and/or pull out the crown to Position 2.
- Adjust the day by turning the crown in the desired direction.
- Gently push in and/or screw down the crown clockwise back into Normal Position to RESET.

Quick Date Setting

- Crown remains in Normal Position.
- Press Pusher A step by step to adjust the desired date.

12H Second Time Zone & Day/Night Indicator Setting

- Crown remains in Normal Position.
- Press Pusher B step by step to adjust the desired 12H second time zone.

Quartz Chronograph Instructions

(ISA8171, ISA8172, ISA8371 or similar)

Watch Functions: Hour, Minute and Chronograph Hands with exposed date aperture on dial. Counter 30 minutes.



Time Setting

- Gently unscrew crown counter-clockwise and/or pull out the crown all the way to Position 3.
- Adjust the time by turning the crown in the desired direction.
- Gently push in and/or screw down the crown clockwise back into Normal Position.

Date Setting

- Gently unscrew crown counter-clockwise and/or pull out the crown to Position 2.
- Adjust the date by turning the crown clockwise to set date.
- Gently push in and/or screw down the crown clockwise back into Normal Position.

Measuring Cumulative Times

Note: After 2 hours of continuous running, the chronograph stops and resets automatically to save battery.



Measuring Split Times



Watch Functions: Hour, Minute and Chronograph Hands with exposed date aperture on dial. Counters 60 Seconds, Day of the Week and 30 Minutes.



Time Setting

- Gently unscrew crown counter-clockwise and/or pull out the crown all the way to Position 3.
- Adjust the time by turning the crown in the desired direction.
- Gently push in and/or screw down the crown clockwise back into Normal Position.

Day Setting

- Gently unscrew crown counter-clockwise and/or pull out the crown all the way to Position 3.
- Adjust the day by turning the crown counter-clockwise the necessary revolutions to change the day. This should always be done before setting the date.
(Please set time according to AM or PM).

Date Setting

- Gently unscrew crown counter-clockwise and/or pull out the crown to Position 2.
- Adjust the date by turning the crown clockwise to set date.
- Gently push in and/or screw down the crown clockwise back into Normal Position.

Resetting Chronograph

- Press and hold down Pusher A and B simultaneously for 2 to 3 seconds. Then to set the minute counter to 30 by pressing down on Pusher B.
- Once set, push down on Pusher A to set chronograph second hand.
- Press Pusher A and B simultaneously to complete the setting.

Note: Never correct date between 9:00PM and 1:00AM.

Watch Functions: Hour, Minute and Chronograph Hands with exposed date aperture on dial. Counters 60 Seconds, 10 Hours or 1/10 Second Chronograph and 30 Minutes.

Time Setting

- Gently unscrew crown counter-clockwise and/or pull out the crown all the way to Position 3.
- Adjust the time by turning the crown in the desired direction.
- Gently push in and/or screw down the crown clockwise back into Normal Position.

Date Setting

- Gently unscrew crown counter-clockwise and/or pull out the crown to Position 2.
- Adjust the date by turning the crown clockwise to set date.
- Gently push in and/or screw down the crown clockwise back into Normal Position.

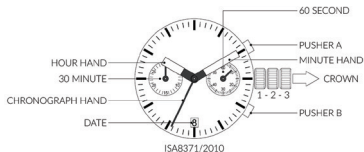

Measuring Cumulative Times

Note: After 2 hours of continuous running, the chronograph stops and resets automatically to save battery.



START
(PUSH THE PUSHER A TO START)



STOP
(PUSH THE PUSHER A TO STOP)



START
(PUSH THE PUSHER B TO RESET)

Measuring Split Times



START
(PUSH THE PUSHER A TO START)



SPLIT
(PUSH THE PUSHER A TO SPLIT)



RESTART
(PUSH THE PUSHER B TO RESTART)



STOP
(PUSH THE PUSHER A TO STOP)



RESET
(PUSH THE PUSHER B TO RESET)

Resetting Chronograph

- Gently unscrew crown counter-clockwise and/or pull out the crown to Position 2.
- Press Pusher A **TWO TIMES** with a time interval of 2 seconds. The hand of counter 9H will make a turn.
- Press Pusher B continually for quick setting and push step by step to adjust the minute.
- Press Pusher A and the second hand will make a turn.
- Press Pusher B continually for quick setting and push step by step to adjust the second.
- Gently push in and/or screw down the crown clockwise back into Normal Position.

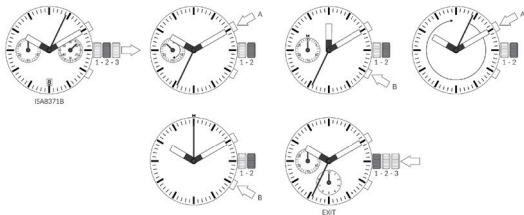

- Gently unscrew crown counter-clockwise and/or pull out the crown to Position 2.
- Press Pusher A, the hand of counter 6H will begin to make a turn.
- Press Pusher B continually for quick setting and push step by step to adjust the hand.
- Press Pusher A, the hand of counter 9H will begin to make a turn.
- Press Pusher B continually for quick setting and push step by step to adjust the minute.
- Press Pusher A and the second hand will make a turn.
- Press Pusher B continually for quick setting and push step by step to adjust the second.
- Gently push in and/or screw down the crown clockwise back into Normal Position.

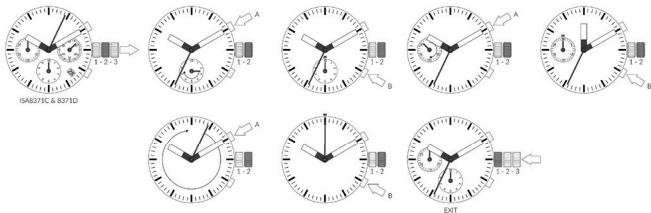

Quartz GMT Instructions

(ISA8173B, ISA8176 or similar)

Watch Functions: Hour, Minute, 24HR GMT and 12HR Alarm Hands with exposed date aperture on dial. Counters 60 Seconds, Day of the Week and Power Reserve.



Time Setting

- Gently unscrew crown counter-clockwise and/or pull out the crown all the way to Position 3.
- Adjust the time by turning the crown in the desired direction.
- Gently push in and/or screw down the crown clockwise back into Normal Position.

Day Setting

- Gently unscrew crown counter-clockwise and/or pull out the crown all the way to Position 3.
- Adjust the day by turning the crown counter-clockwise the necessary revolutions to change the day. This should always be done before setting the date.

(Please set time according to AM or PM).

Date Setting

- Gently unscrew crown counter-clockwise and/or pull out the crown to Position 2.
- Adjust the date by turning the crown clockwise to set date.
- Gently push in and/or screw down the crown clockwise back into Normal Position.

Alarm and Power Reserve Setting

Movement with Alarm Repetition: If the alarm is not switched off during the first ringing, a second alarm will occur after 2 minutes.



Second Time Zone Setting



Watch Functions: Hour, Minute and 24HR GMT Hands with exposed date aperture on dial. Counters 60 Seconds.

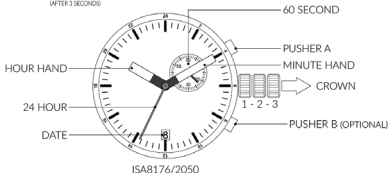

Time Setting

- Gently unscrew crown counter-clockwise and/or pull out the crown all the way to Position 3.
- Adjust the time by turning the crown in the desired direction.
- Gently push in and/or screw down the crown clockwise back into Normal Position.

Date Setting

- Gently unscrew crown counter-clockwise and/or pull out the crown to Position 2.
- Adjust the date by turning the crown clockwise to set date.
- Gently push in and/or screw down the crown clockwise back into Normal Position.

Second Time Zone Setting

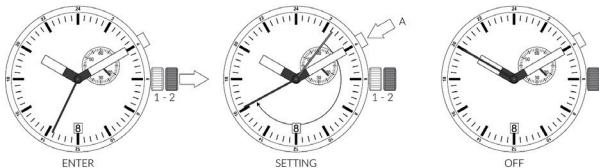

Automatic Instructions and Maintenance

Automatic movements contain no battery, they are powered by a coiled mainspring that is charged by either winding manually by the crown, or from the rotating pendulum (rotor) attached to the movement that rotates through the natural movements of your arm while wearing the watch. In this instance, the watch is “self-winding”, and will continue to charge at all times while being worn. When an automatic watch is not worn, and not manually wound by the crown, it will wind down and stop running. You only need to give the watch a shake, or wind the crown to revive the automatic movement again.

HOW IT WORKS: An automatic movement is also known as “self-winding” because it has the ability to wind itself through the movement of your wrist while the watch is being worn. The movement of your arm causes the rotor, a metal pendulum attached to a set of winding gears, to spin. Even the slightest action of the wrist will cause the rotor to rotate back and forth in a circular motion. As the rotor moves, it transfers the energy through the winding gears to the mainspring, which stores the energy required to power the function of the watch.

MAINTENANCE: If you select a automatic watch, you should be sure to get it serviced at regular intervals. Like any fine machine (your car, lawnmower or boat), regular maintenance and care will extend the life of this finely tuned machine, and keep everything in proper running order.

We suggest that you service and lubricate your movement every three to five years to maintain the finest level of accuracy and reliability. If you are relying on your watch for diving purposes, or it is exposed to water and/or excessive temperature ranges often, you should service your watch annually to replace vital seals & gaskets to maintain the proper water resistance.

HOW TO START THE WATCH: Gently unscrew crown counter-clockwise and/or pull out the crown. Gently rotate the crown in a continuous clockwise rotating motion, to add power to the mainspring and wind up your watch. It will only take a couple of turns to get the watch going, but generally it can take 30-40 rotations of the crown to FULLY wind the watch to its maximum potential power reserve.

To initially start your watch: Swing it from side to side in a horizontal arc for about 30 seconds.

- If the watch is worn on the wrist, the mainspring will be wound automatically through normal wrist movement.
- If the watch is used without being wound up sufficiently, gain or loss of the watch may result.

To avoid this, wear the watch for more than 8 hours a day.



Deployment Clasp and Buckle Instructions

INSTRUCTIONS FOR PUSH BUTTON DEPLOYMENT AND HIDDEN CLASP

(Bracelet and Strap)

Important: Please place watch on non-abrasive surface before adjusting deployment clasp.

1. Push the 2 Clasp Release Buttons on either side of the bracelet to release the clasp.

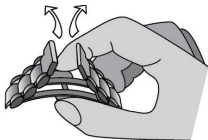
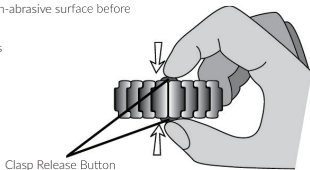

2. The Bracelet will release and open in an upward and outward motion as illustrated.

Note: If links need to be removed, please go to an Authorized Elini Barokas Repair Center or reputable jeweler. Witness Watch Co. and Elini Barokas will not be liable for damages carried out by anyone other than ourselves.

1. Push the 2 Clasp Release Buttons on either side of the Buckle to release the clasp.

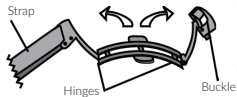
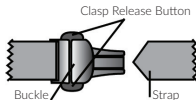

2. The Buckle will release and open in an upward and outward motion on small hinges.

3. When opened, the Buckle Clip may be popped open to allow insertion of the loose strap end to be pushed through and locked in place by the Pin.

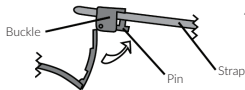
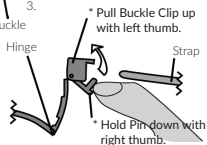

4. Once the strap is positioned the buckle clip may be locked in place. You may then put the watch on and fold both ends of the buckle back down until they lock into place.

*Please visit www.witnesswatch.com/help for a detailed step-by-step instruction video.

Water Resistance Diagram

Watches are ranked I through V for water resistance. Check the ranking of your watch in the following chart to determine proper use.

Rank	Case Designation	Splashes, Rain etc	Swim car-wash	Snorkeling	Scuba Diving
I	-	NO	NO	NO	NO
II	30M Water Resistant	YES	NO	NO	NO
III	50M Water Resistant	YES	YES	NO	NO
IV	100M Water Resistant	YES	YES	YES	NO
V	200M Water Resistant or greater	YES	YES	YES	YES

Guide

- I Note water-resistant. Avoid all moisture.
- II Do not operate buttons underwater.
- III If watch is exposed to salt water, wash thoroughly and dry.
- V Usable while scuba diving (except at depths that require helium-oxygen gas).

SAPPHITEK™ Crystal Warranty

ELINI BAROKAS takes pride in manufacturing timepieces using the highest standards for material and craftsmanship.

Most ELINI BAROKAS timepieces are equipped with a SAPPHITEK™ crystal which is protected by a 5-year limited warranty against deep scratches and cracks. ELINI BAROKAS is the proud trademark owner and exclusive supplier of SAPPHITEK™ crystals. For warranty information on other aspects of your watch please refer to the warranty that came with your ELINI BAROKAS timepiece.

SAPPHITEK™ crystals exhibit superior impact resistance to commonly used sapphire crystals, since they are manufactured utilizing a pure multi-material, high-heat process.

ELINI BAROKAS chooses SAPPHITEK™ crystals because they are more resistant to shock, heat and wear, and can withstand higher water pressure.

This warranty is only valid with watches that contain SAPPHITEK™ crystals.



"Beyond Telling Time"

WITNESS WATCH CO.

3701 S. Flamingo Road, Suite 100, Miramar, FL 33027

Toll Free : 1-844-WWC-TIME

Fax : 1-945-985-1828

In case your movement is not listed in this manual please visit www.witnesswatch.com for a full list of detailed instructions.



"Beyond Telling Time"

WITNESS WATCH CO.

3701 S. Flamingo Road, Suite 100, Miramar, FL 33027

Toll Free : 1-844-WWC-TIME

Fax : 1-945-985-1828

**ELINI BAROKAS
IS PART OF :**



www.witnesswatch.com/elini-barokas
help@witnesswatch.com



WITNESS WATCH CO.

#ELINIBAROKAS